

"Oh! There's no use scratching  
on the blind."

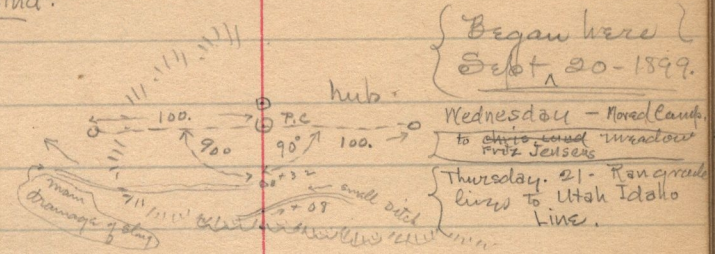

The Slough

Road to Fence

Franklin  
being a dry run.

Road

Fence 84 W

The Slough

Requires Flume

25. Irrigation ditch

Road to water

74.3

+ 80

Christian J. Iwertson's  
windmill.

{ John Maughan owns 40 acres }  
adjacent on the East.

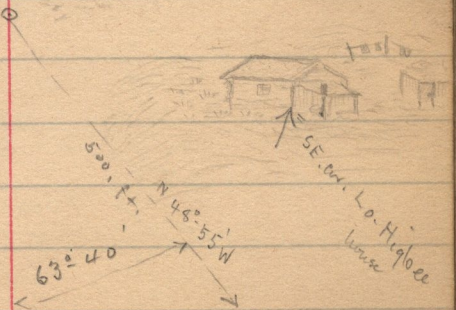

63-40  
N 14-45 E  
N 48-55 W